

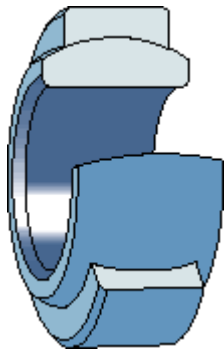

Rótulas

Combinación de superficie de contacto acero/acero (que requieren mantenimiento)



GE .. E
d = 4 - 12 mm

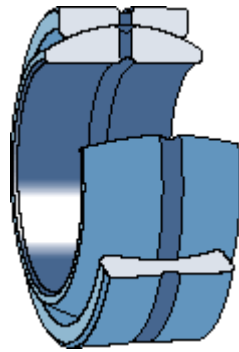

GE .. ES
d = 15 - 200 mm

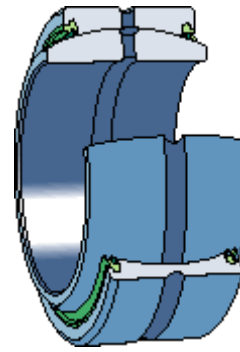

GE .. ES-2RS
d = 20 - 300 mm

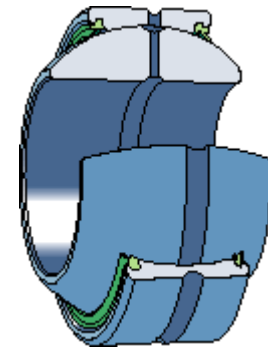

GEH .. ES-2RS
d = 20 - 120 mm

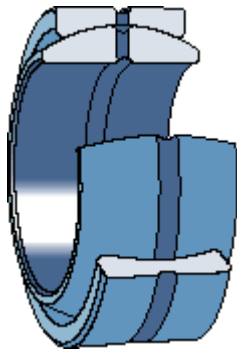

GEZ .. ES
d = 1/2 - 6 inch

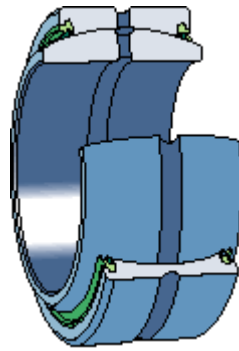

GEZ .. ES-2RS
d = 1 - 6 inch

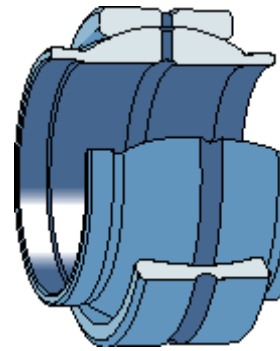

GEG .. ES
d = 12 - 200 mm
GEZM .. ES
d = 1/2 - 6 inch

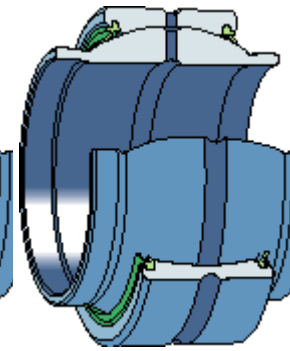

GEM .. ES-2RS
d = 20 - 80 mm
GEZM .. ES-2RS
d = 3/4 - 6 inch

Combinación de superficie de contacto acero/compuesto de bronce sinterizado (libres de mantenimiento)

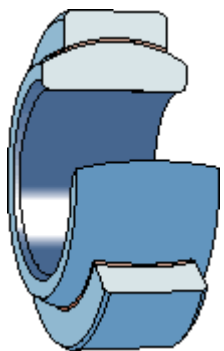

GE .. C
d = 4 - 30 mm
GE .. CJ2
d = 35 - 60 mm

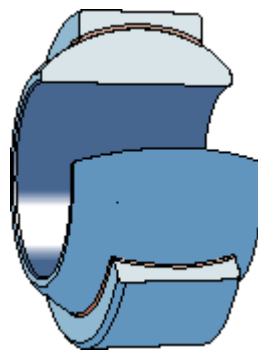

GEH .. C
d = 10 - 25 mm



Combinación de superficie de contacto acero/tejido PTFE (libres de mantenimiento)

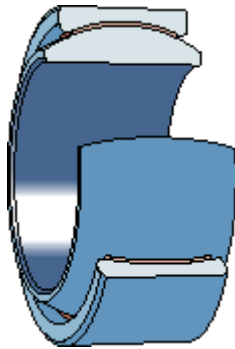

GE .. TXGR
d = 12 - 17 mm

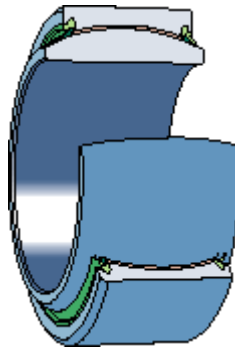

GE .. TXE-2LS
d = 20 - 90 mm
GEZ .. TXE-2LS
d = 1 - 3,75 inch
GE .. TXG3E-2LS
d = 20 - 60 mm

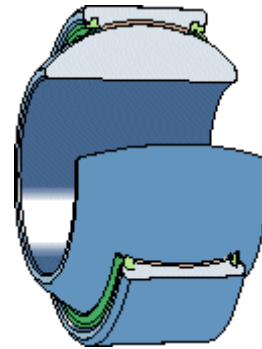

GEH .. TXE-2LS
d = 20 - 80 mm
GEH .. TXG3E-2LS
d = 20 - 50 mm

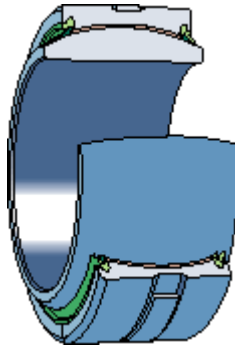

GE .. TXA-2LS
d = 100 - 300 mm
GEZ .. TXA-2LS
d = 4 - 6 inch
GE .. TXG3A-2LS
d = 70 - 200 mm

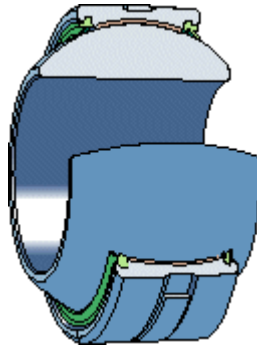

GEH .. TXA-2LS
d = 90 - 120
GEH .. TXG3A-2LS
d = 60 - 120 mm

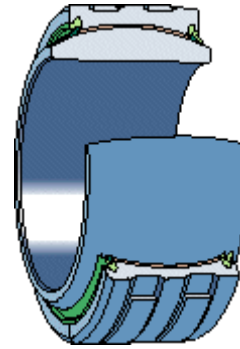

GEC .. TXA-2RS
d = 320 - 400

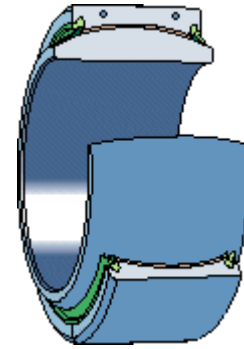

GEC .. TXA-2RS
d = 420 - 800

Combinación de superficie de contacto acero/compuesto PTFE (libres de mantenimiento)

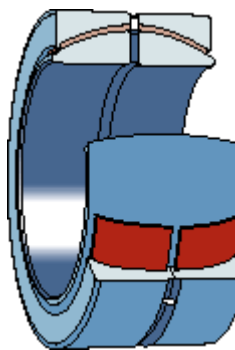

GEP .. FS
d = 100 - 1 000 mm

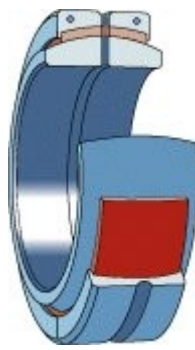

GEC .. FBAS
d = 320 - 1 000 mm

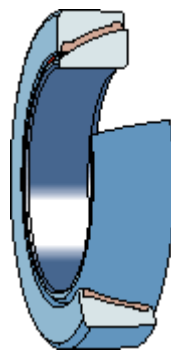

GAC .. F
d = 25 - 120 mm

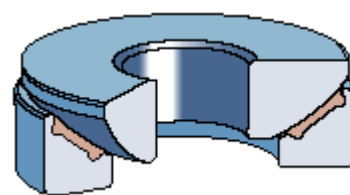

GX .. F
d = 17 - 120 mm